

MEETING ROOM



THE VIEW Lugano is a boutique hotel of the Planhotel Hospitality Group.

Of the 18 rooms, 16 are Junior Suites and 2 are Suites, all set in an exceptional location with a breathtaking view over the Lake of Lugano and offering a Smart Luxury approach with great attention paid to the needs and the preferences of guests.

THE VIEW Fine Dining Restaurant and the TRECINQUEZERO Terrace,

are ideally located and offer a gastronomic experience that is distinguished, versatile and exclusive. The kitchen, which is led by Chef Mauro Grandi, combines tradition, creativity and local products, to create a symphony of delicious flavors and surprising details.

The gentle perfume of essential oils permeates through the intimate and secluded atmosphere of THE VIEW Lugano SPA, a charming Olympus designed for hotel guests, but also open to external visitors and where every detail is dedicated to wellbeing.

MEETING ROOM

INFO & PLAN

4 - 5

SET UP

6 - 10

Theatre style

6

Conference

7

U-shape

8

Classroom

9

1/2 Room

10

PACK

11 - 13

Deluxe Package - Half Day

11

Deluxe Package - Full Day

11

Premium Package - Half Day

12

Premium Package - Full Day

12

Escape Meeting

13

Evening Meeting

13



INFO

GRANDE SALA

Size: 89 sqm

Full day price

CHF 1500.-

Half day price

CHF 1000.-

1/2 SALA

Size: 41/48 sqm

Full day price

CHF 1000.-

Half day price

CHF 600.-

INCLUDED in the price:

- 82" touchscreen Videowall with sound system
- Small stationary material
- Paper sheets flipchart
- Digital flipchart
- Wi-fi

EXTRA:

Wireless microphone: CHF 100.-



PLAN

- (A) 82" TV Screen
- (B) Lectern
- (C) Sliding window
- (D) Emergency sliding window
- (E) Entrance/Exit
- (F1) Sideboard 252x40mm
- (F2) Sideboard 190x40mm
- (G1) Closed partition wall
- (G2) Opened partition wall
- Wall power plugs
- Floor power boxes

RECEPTION

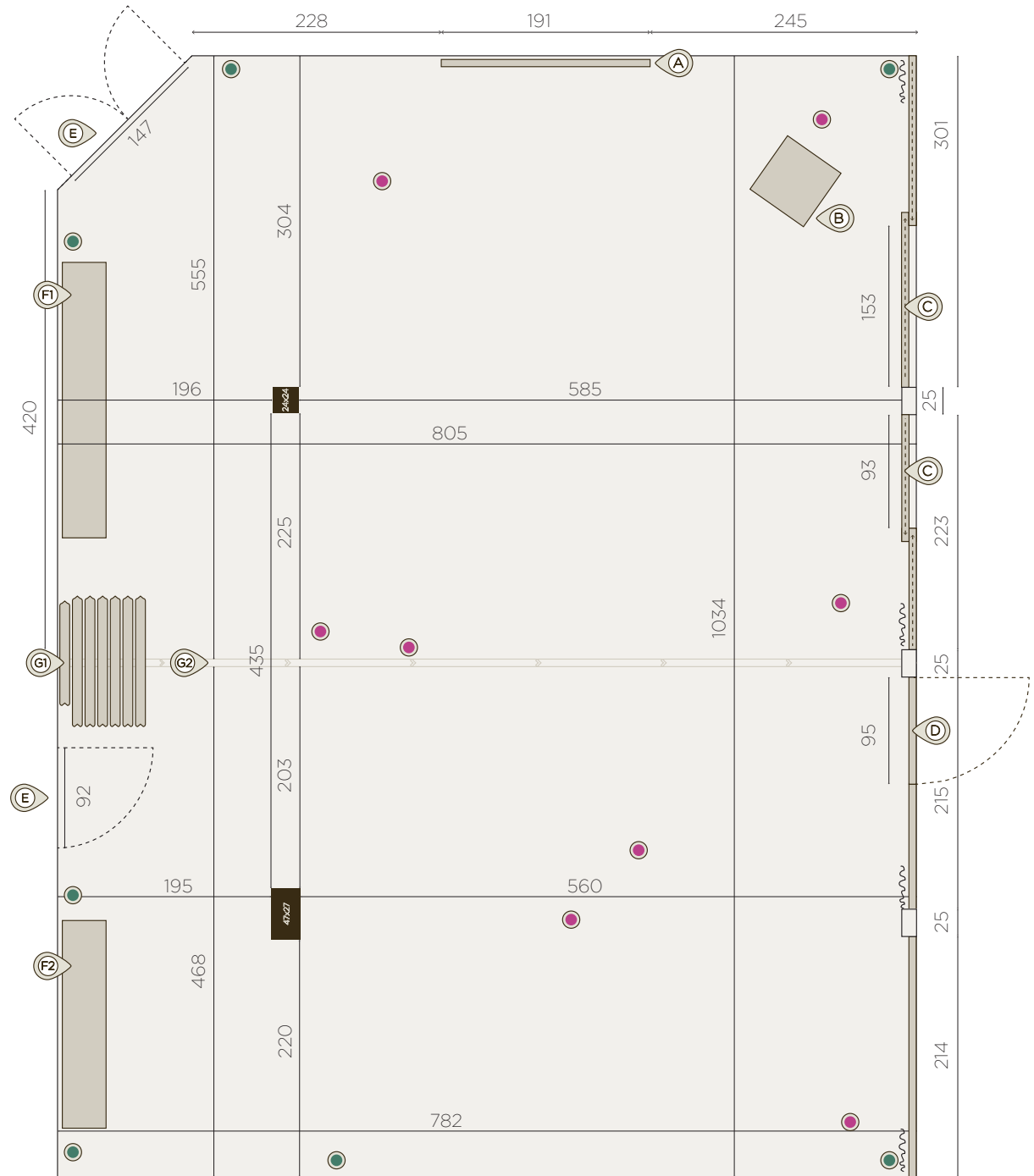

TERRACE OVERLOOKING THE LAKE

SET UP 01

THEATRE STYLE

Capacity: 70 pax max

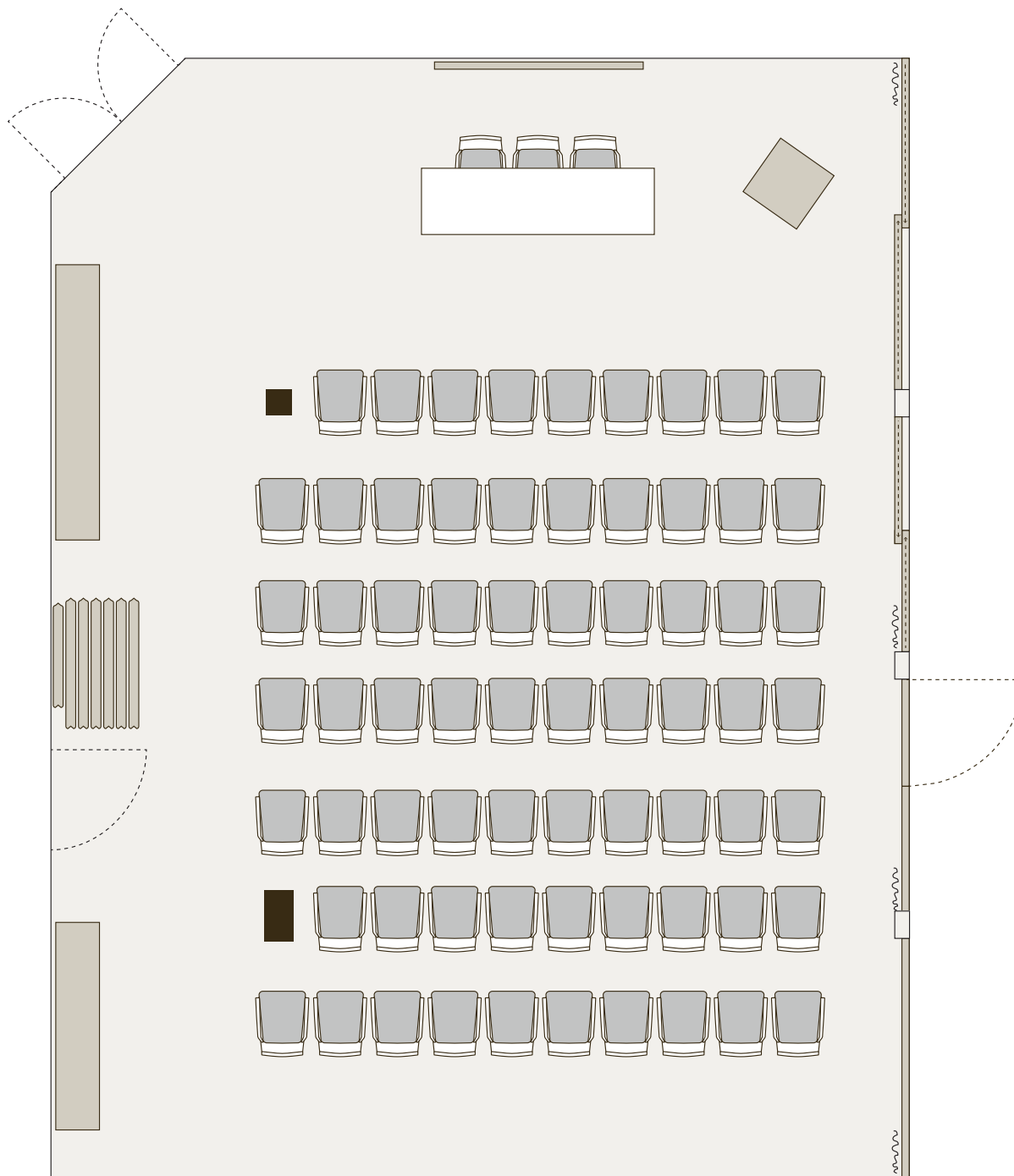

SET UP 02

CONFERENCE

Capacity: 20 pax max

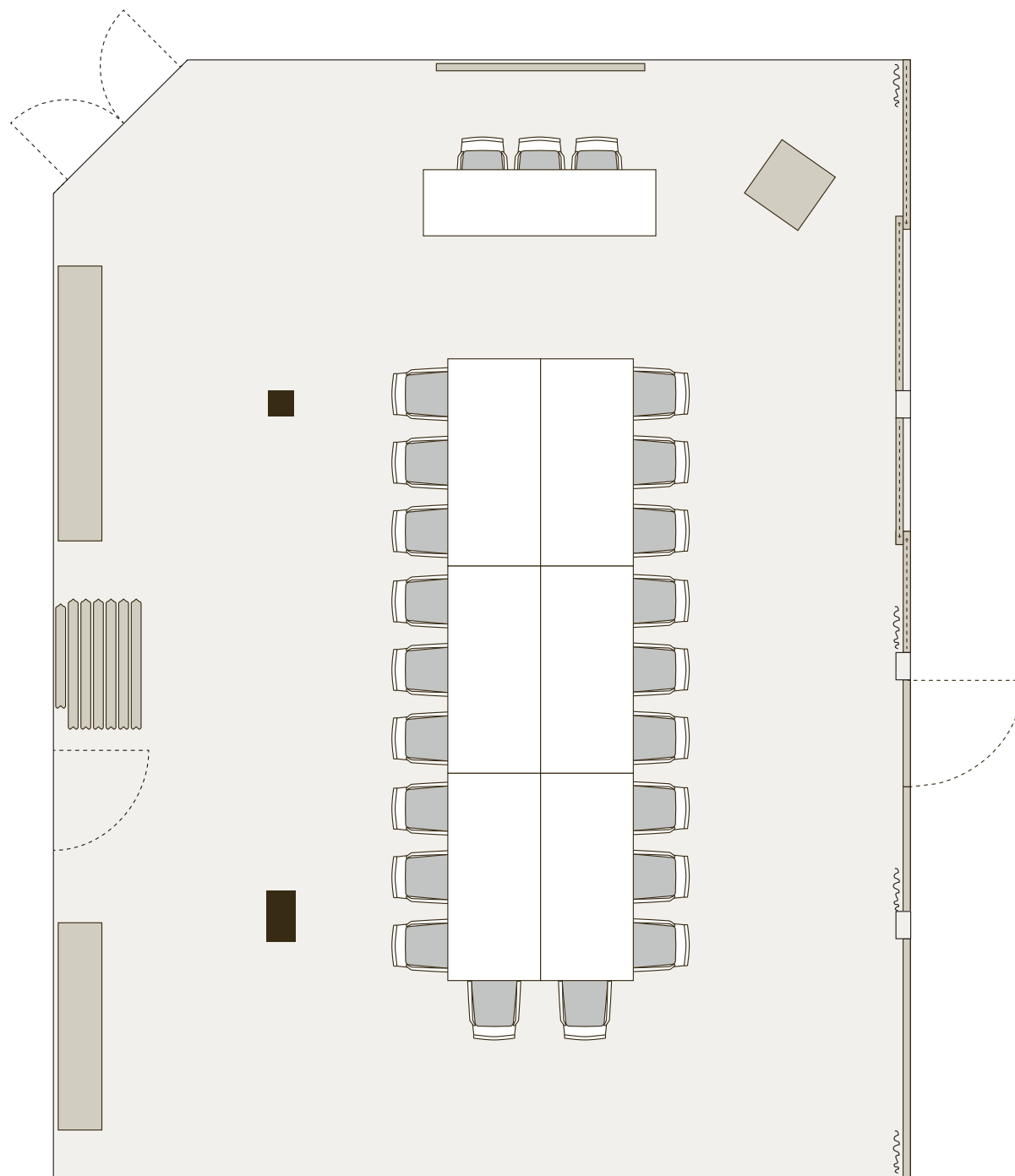

SET UP 03

U-SHAPE

Capacity: 20 pax max

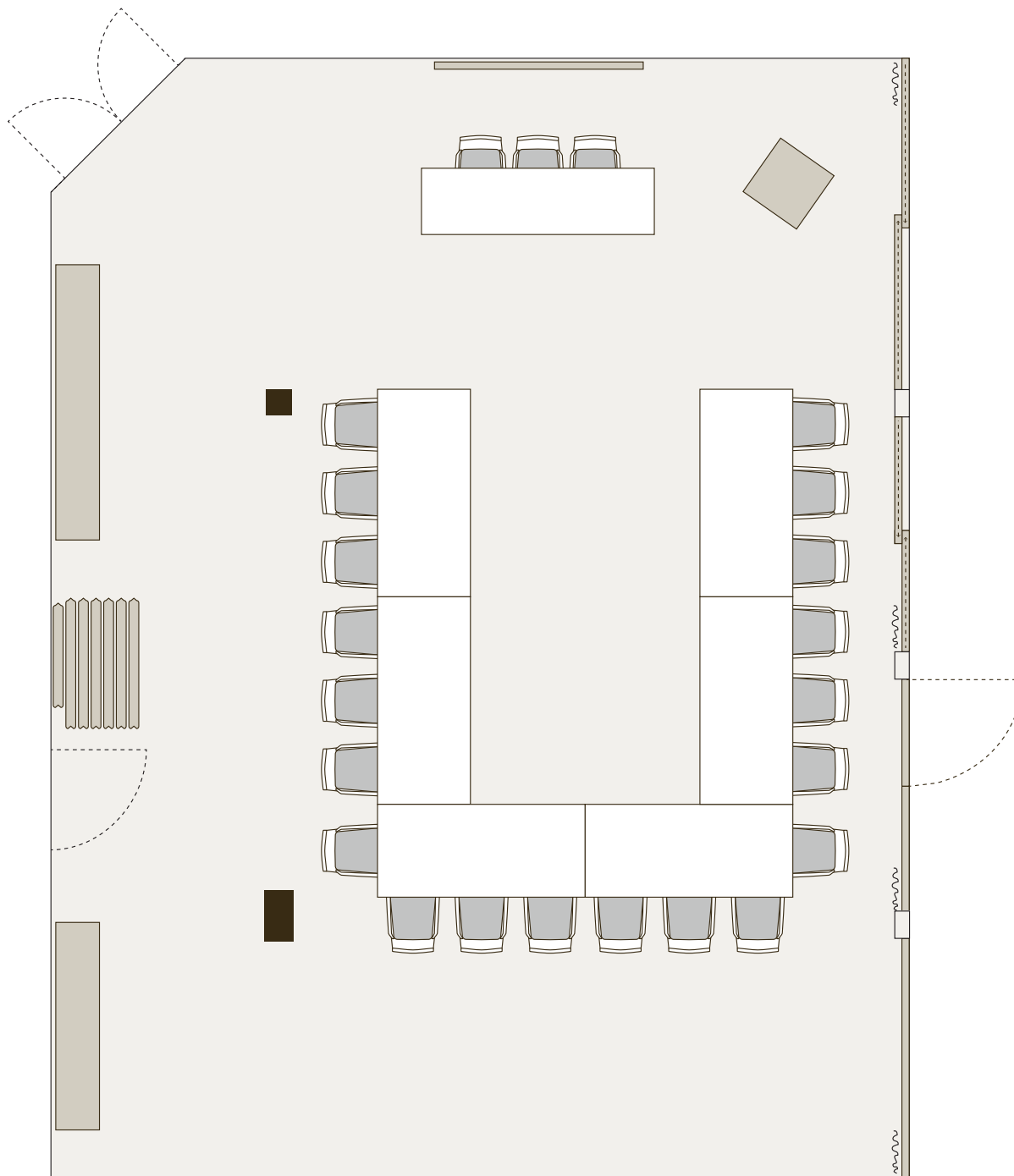

SET UP 04

CLASSROOM

Capacity: 12 pax max

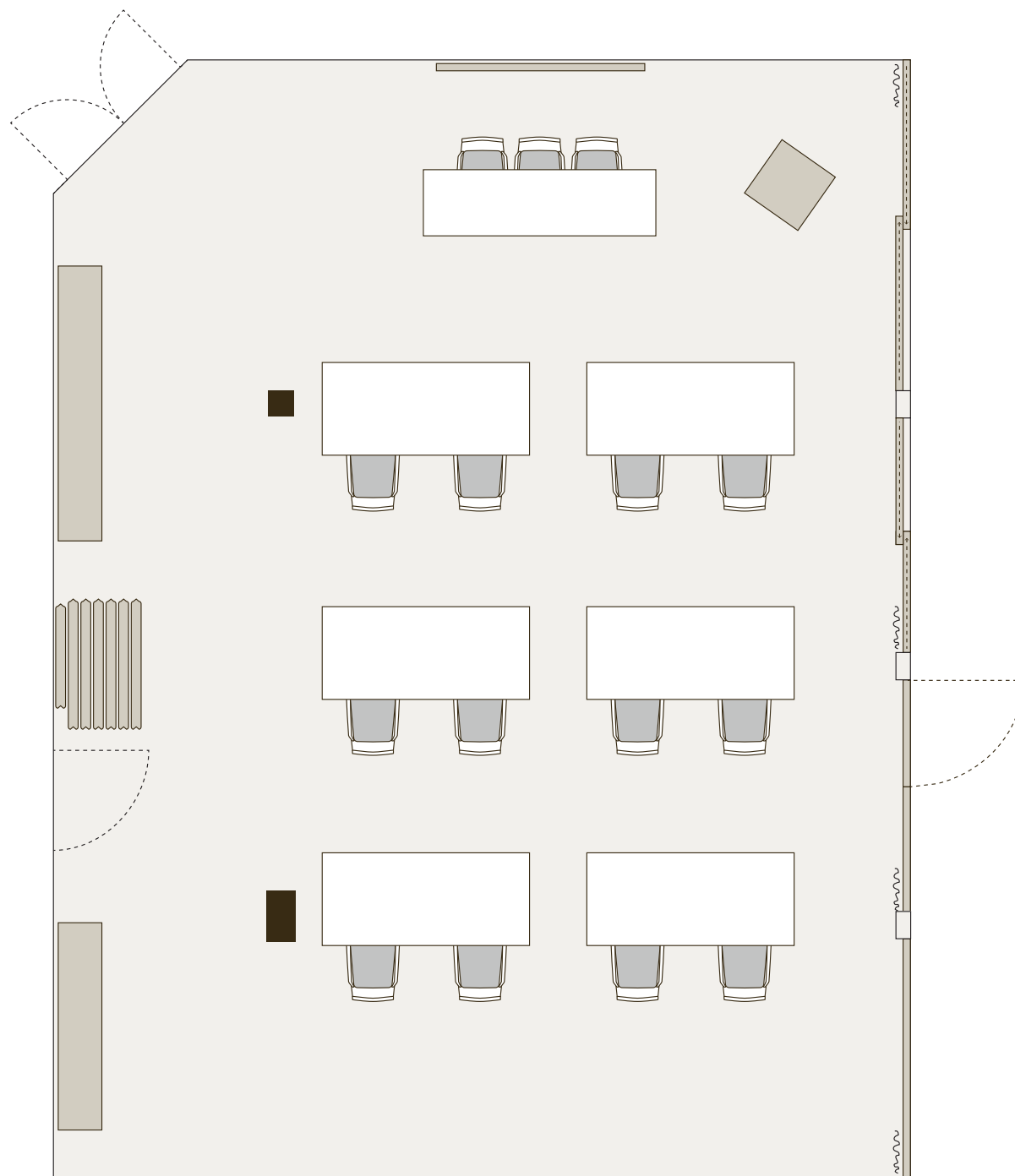

SET UP 05 o 6

1/2 ROOM THEATRE STYLE

Capacity: 30 pax max

or

1/2 ROOM CONFERENCE

Capacity: 16 pax max

