



# DIAMONDS

CONFERENCE CENTER  
MALINDI

## Venues size and areas

Venue	Area	Lenght	Width	Height
Main Hall	435 sqm	15 m	29 m	4,2 m
Hall 1	215 sqm	15 m	14,5 m	4,2 m
Hall 2	215 sqm	15 m	14,5 m	4,2 m
Boardroom 1	42 sqm	10 m	5 m	3,6 m
Boardroom 2	42 sqm	10 m	5 m	3,6 m

## Equipment

### Halls

- Main control room
- Centralized air conditioning
- In built sound system with speakers in the ceiling
- Lapel Microphones and cordless microphones
- Touch screen audio controls
- Led lighting that can change the room into blue, green yellow or red
- 2 Samsung 2m x 3.6m led screens
- Wi-Fi internet

### Board Rooms 1 and 2

- Samsung digital 55inch flip chart with advanced touch screen technology
- Wi-Fi internet

## Services

2 Toilet, one on each side of the buidling

- 2 gents bathroom with 4 urinals and 2 toilets
- 2 ladies bathroom with 2 toilets
- 1 Disabled bathroom

## Capacities

Venue	Cinema	Class Room	U Shape	Double U Shape
Main Hall	400	280	na	na
Hall 1	200	140	48	80
Hall 2	200	140	48	80
Boardroom 1	42	20	na	na
Boardroom 2	42	20	na	na

Venue	Cabaret	Columns	Horse Shoe	T Shape
Main Hall	120	192	na	na
Hall 1	60	96	60	38
Hall 2	60	96	60	38
Boardroom 1	na	na	na	na
Boardroom 2	na	na	na	na

Venue	Boardroom	Banquet
Main Hall	na	250 (stage + dancefloor)
Hall 1	32	100
Hall 2	32	100
Boardroom 1	24	na
Boardroom 2	24	na

# Floor plan

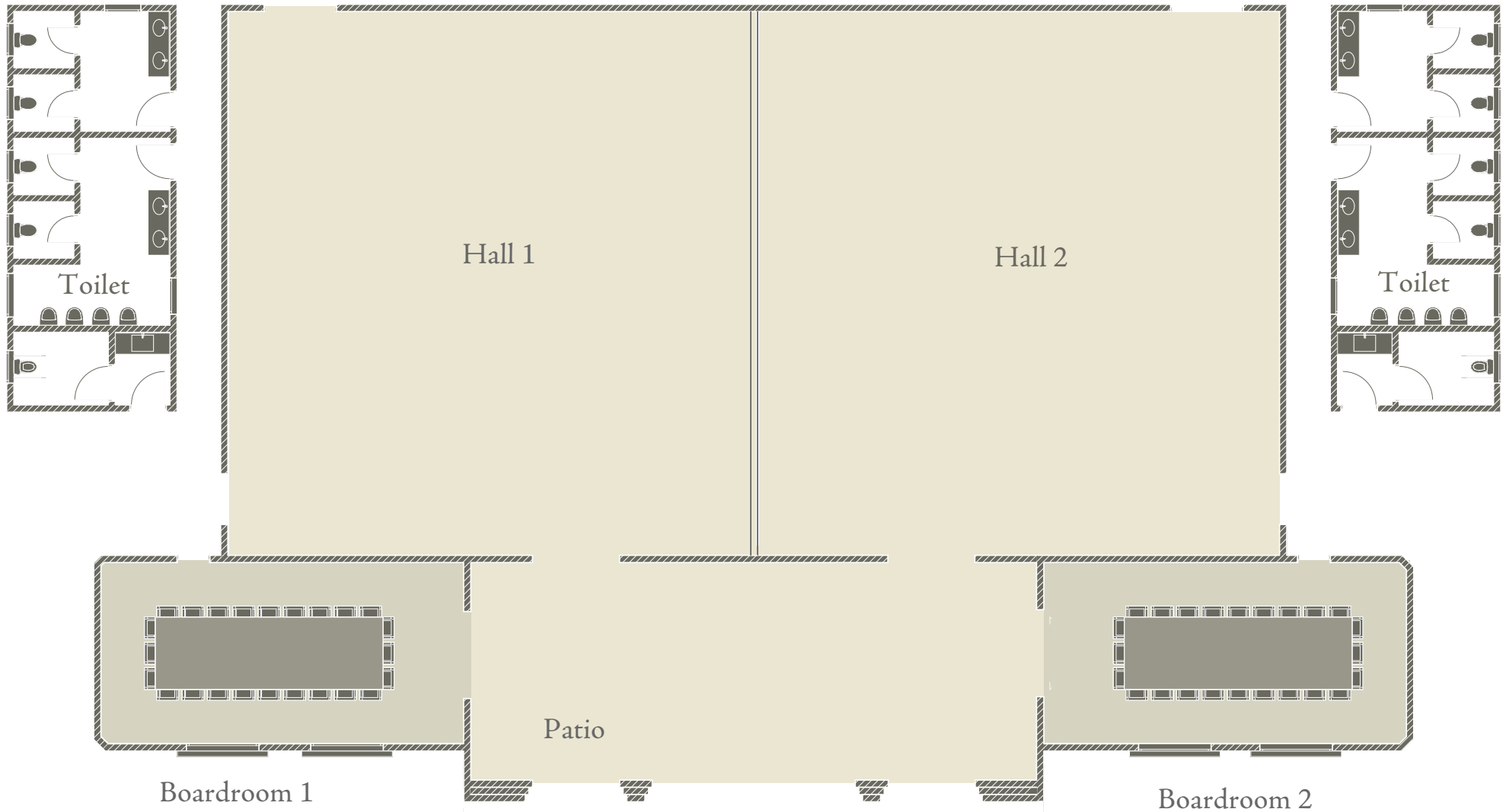

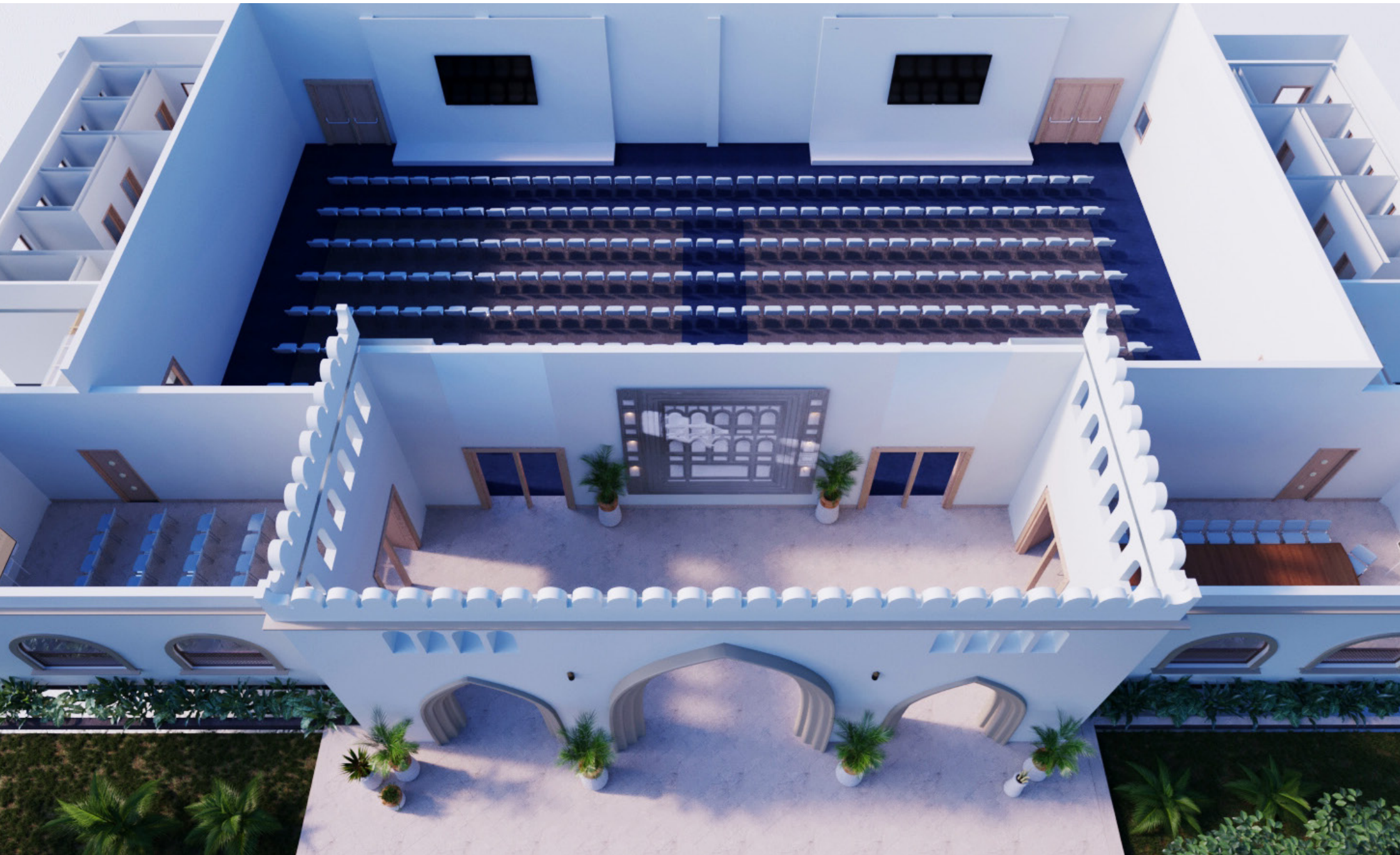

### Main Hall: Banquet set up 250 pax

Buffet to be served in the boardrooms and in the patio  
30 tables set up is possible without the dance floor

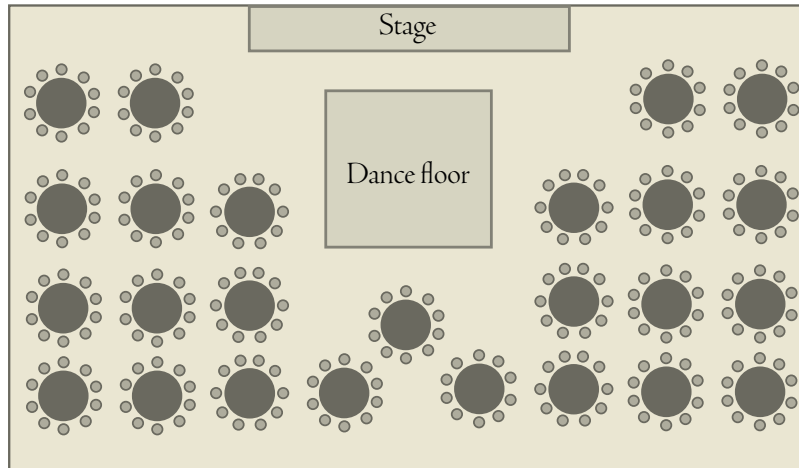

### Main Hall: Cinema set up 400 pax

Separate Hall 1 and Hall 2 option: 200 pax each hall

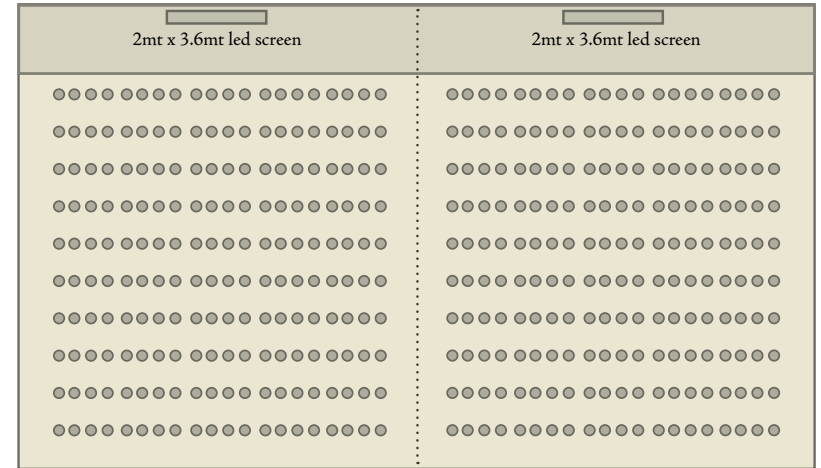

### Main Hall: Cabaret set up 120 pax

Separate Hall 1 and Hall 2 option: 60 pax each hall

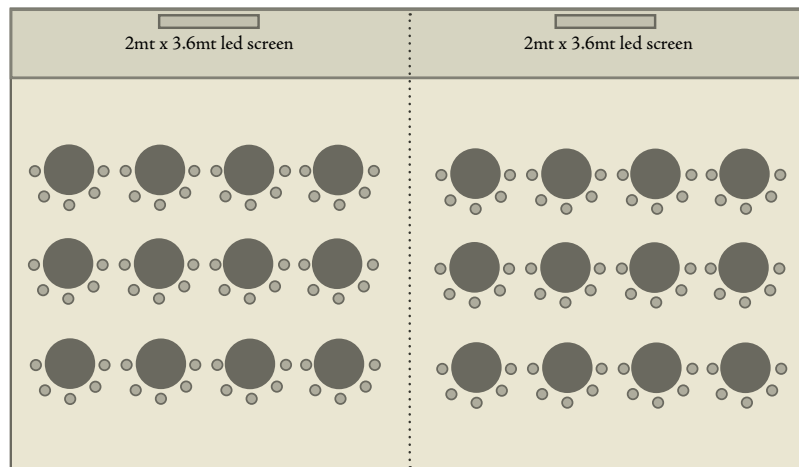

### Main Hall: Classroom set up 280 pax

Separate Hall 1 and Hall 2 option: 140 pax each hall

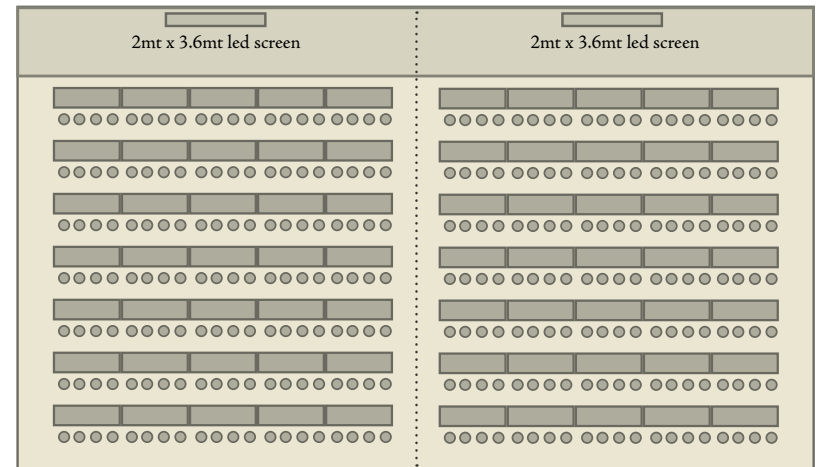

Hall 1 and Hall 2: U shape set up 48 pax

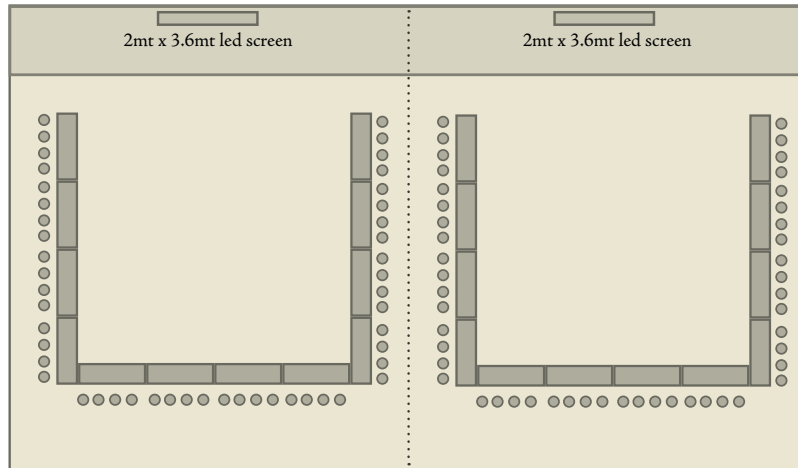

Hall 1 and Hall 2: Horse Shoe set up 60 pax

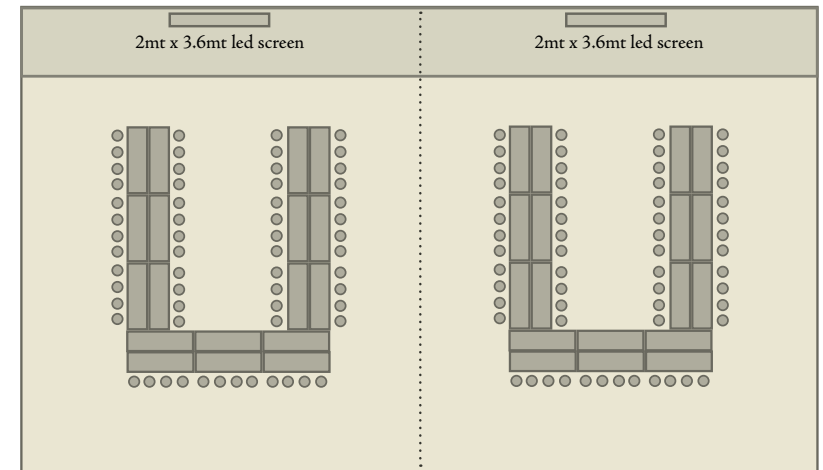

Hall 1 and Hall 2: Double U shape us set up 80 pax

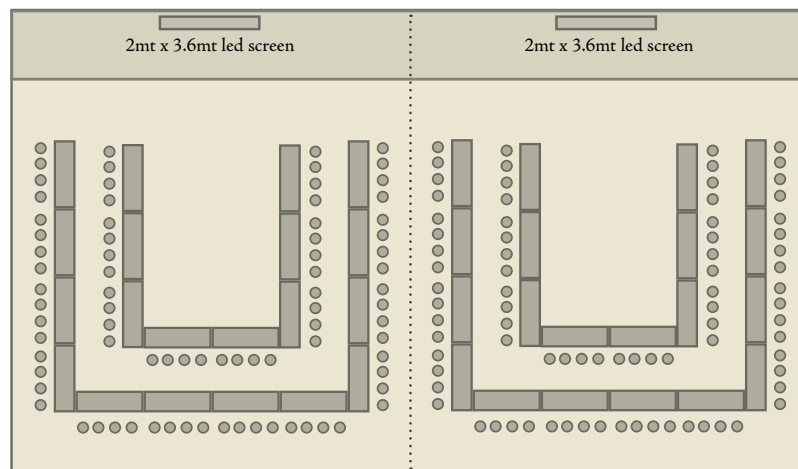

Hall 1 and Hall 2: T Shape set up 38 pax

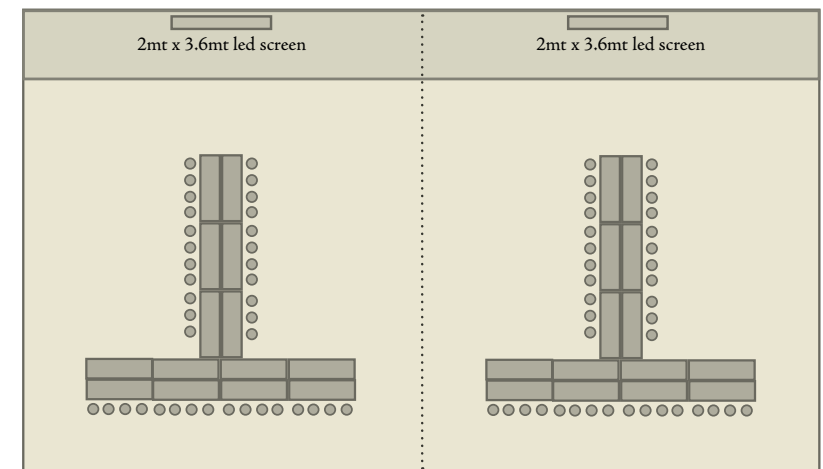

Hall 1 and Hall 2: Boardroom set up 32 pax

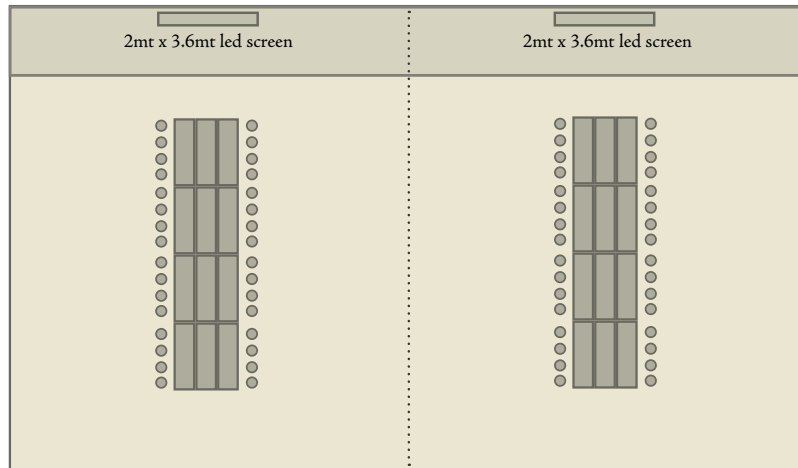

Hall 1 and Hall 2: Columns us set up 96 pax

